

GME Secondary

February 2020

Sites / Locations

Funding

Statutory
Consultation

November 2020

Design,
Development,
Construction

August 2024

Dedicated
GME
Secondary
School

Site Options

- 2 shared campus options
- Castlebrae
- Granton Waterfront

August 2019: New temporary classrooms

August 2021 – August 2024:
Darroch provides short-medium terms solution

Option Appraisal

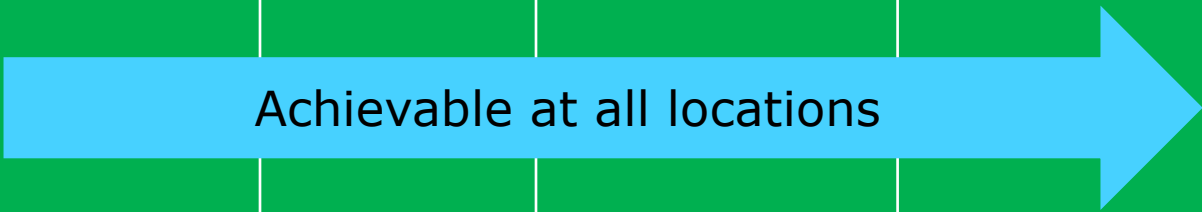
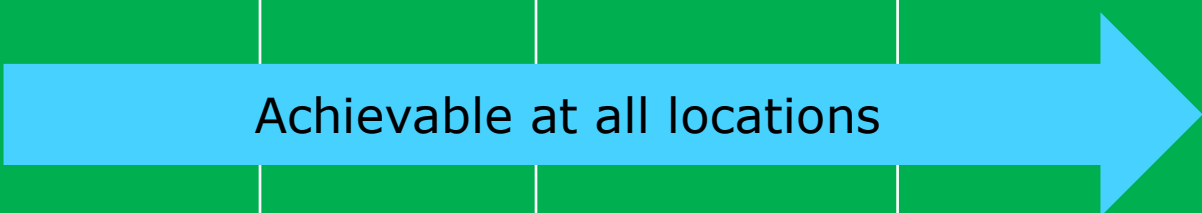
	Liberton	WHEC	Granton	Castlebrae
Supports Educational Aims	Achievable at all locations 			
Suitability for City Wide Catchment	Central location Good Public transport Links	Peripheral Location Good Public Transport Links	Peripheral Location Public transport links limited	Peripheral Location Public transport links limited
Design and Environment	Achievable at all locations 			
Deliverability	Potential Funding options	Funding options limited Site limitations	Funding options limited Site tbc Land Costs ++	Funding options limited Land Costs ++



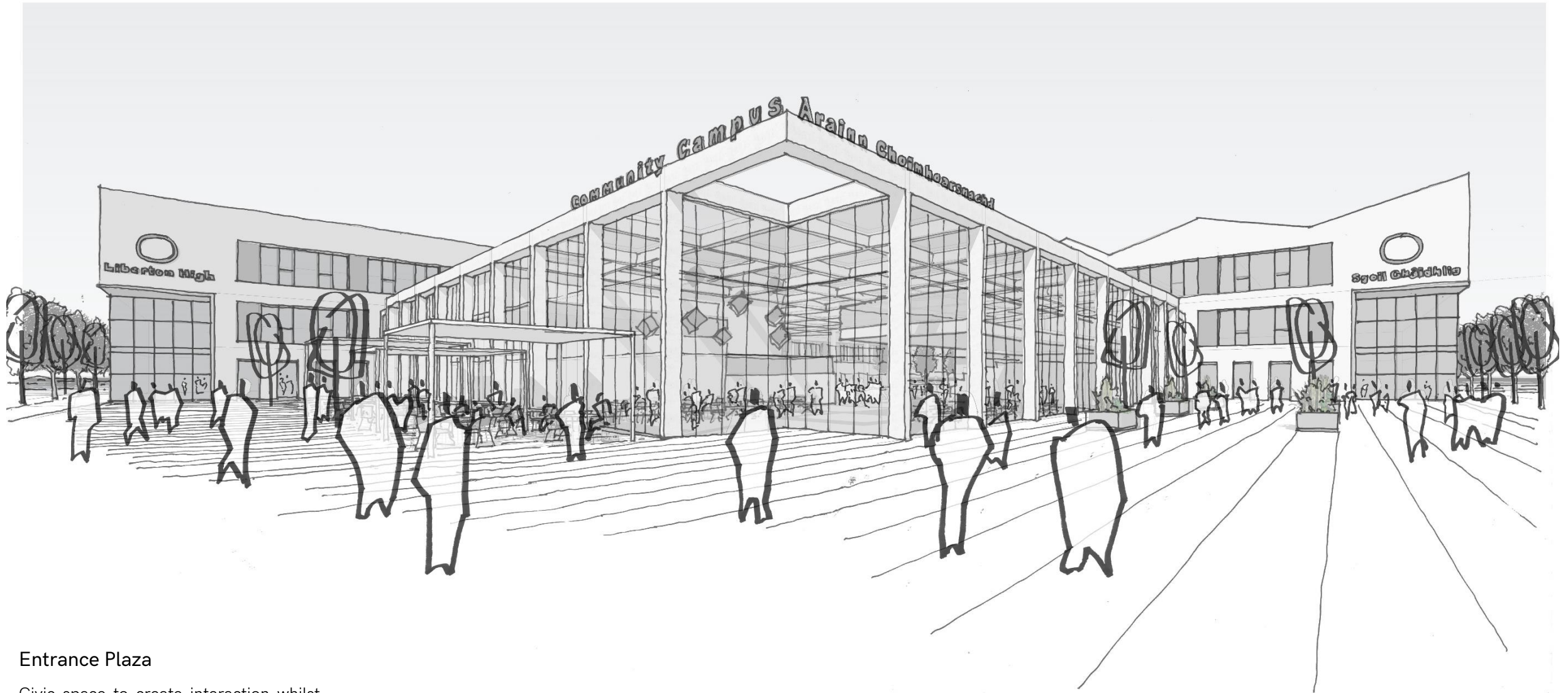

Entrance Plaza

Civic space to create interaction whilst maintaining clear segregation

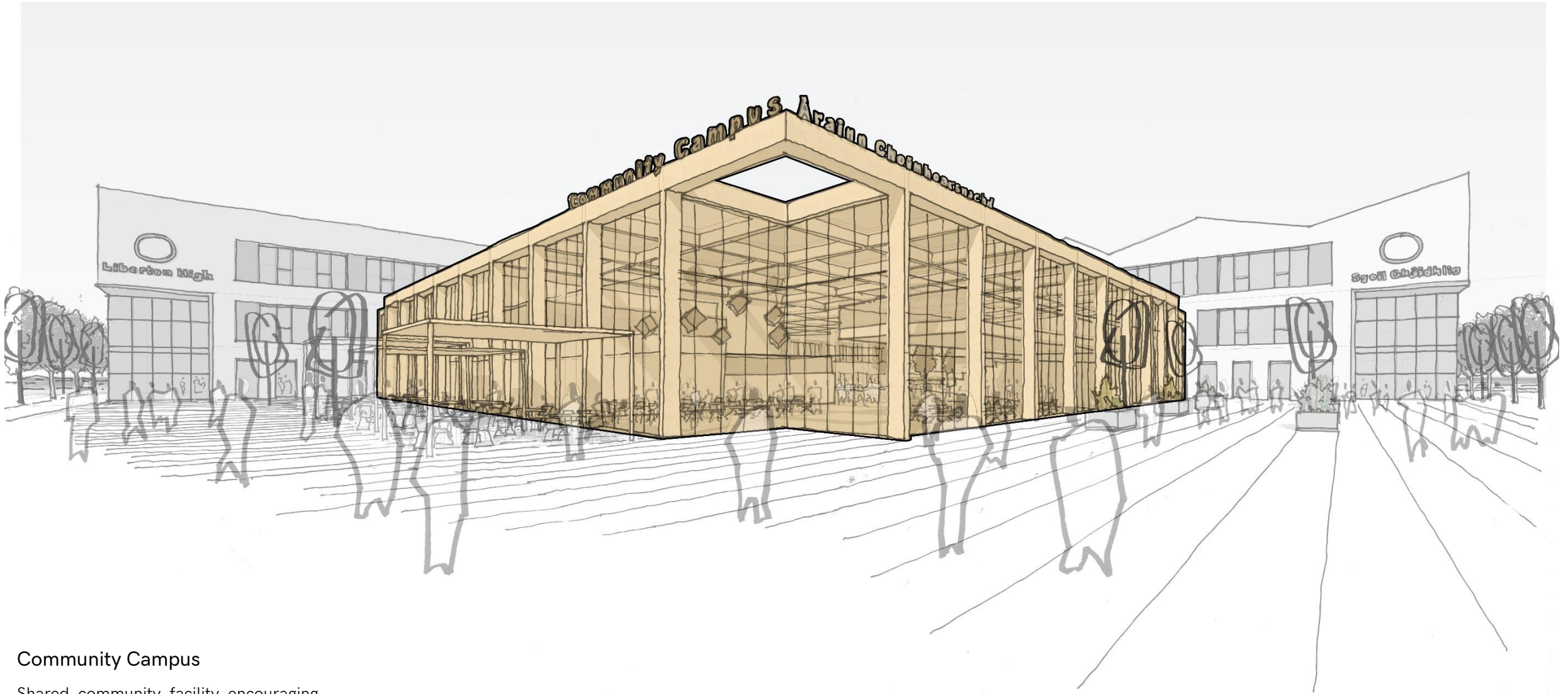

Community Campus

Shared community facility encouraging interaction and openness

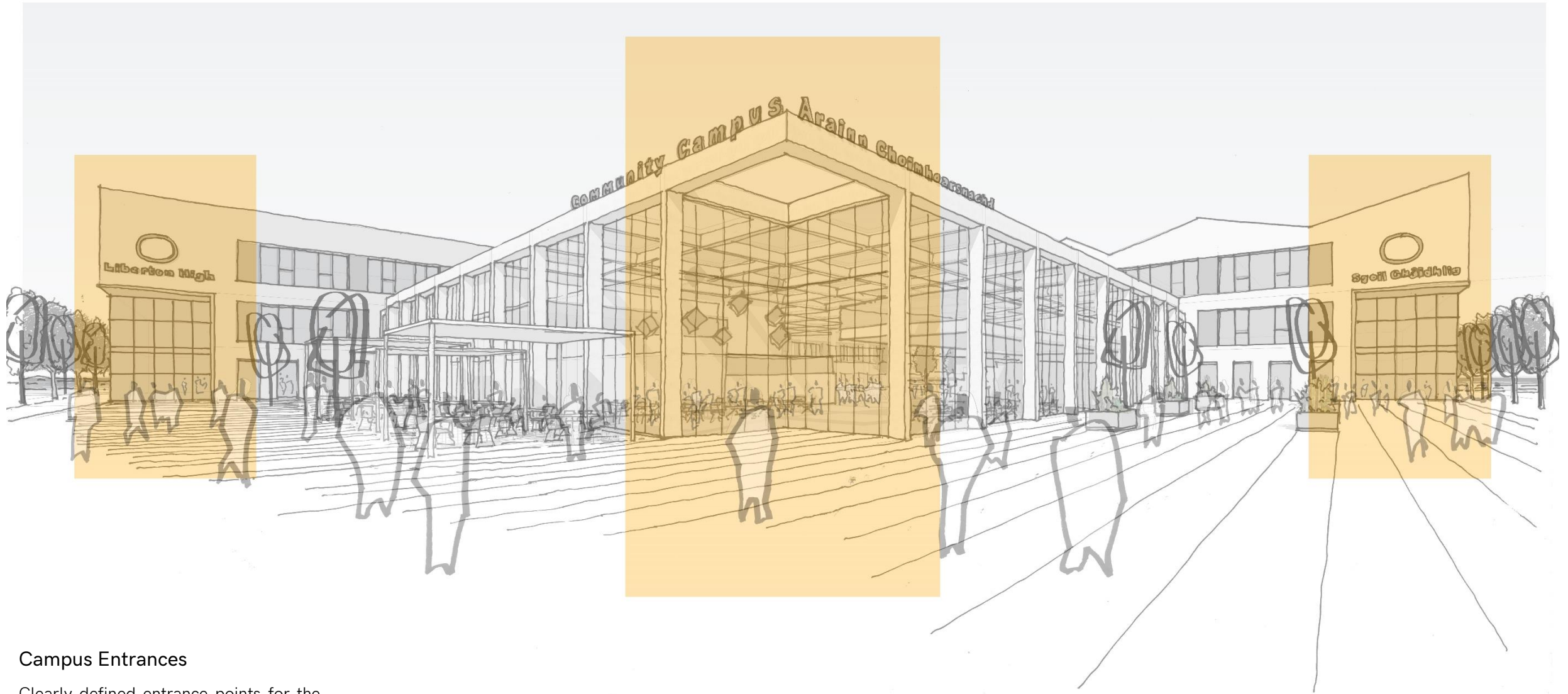

Campus Entrances

Clearly defined entrance points for the shared campus and the separate schools

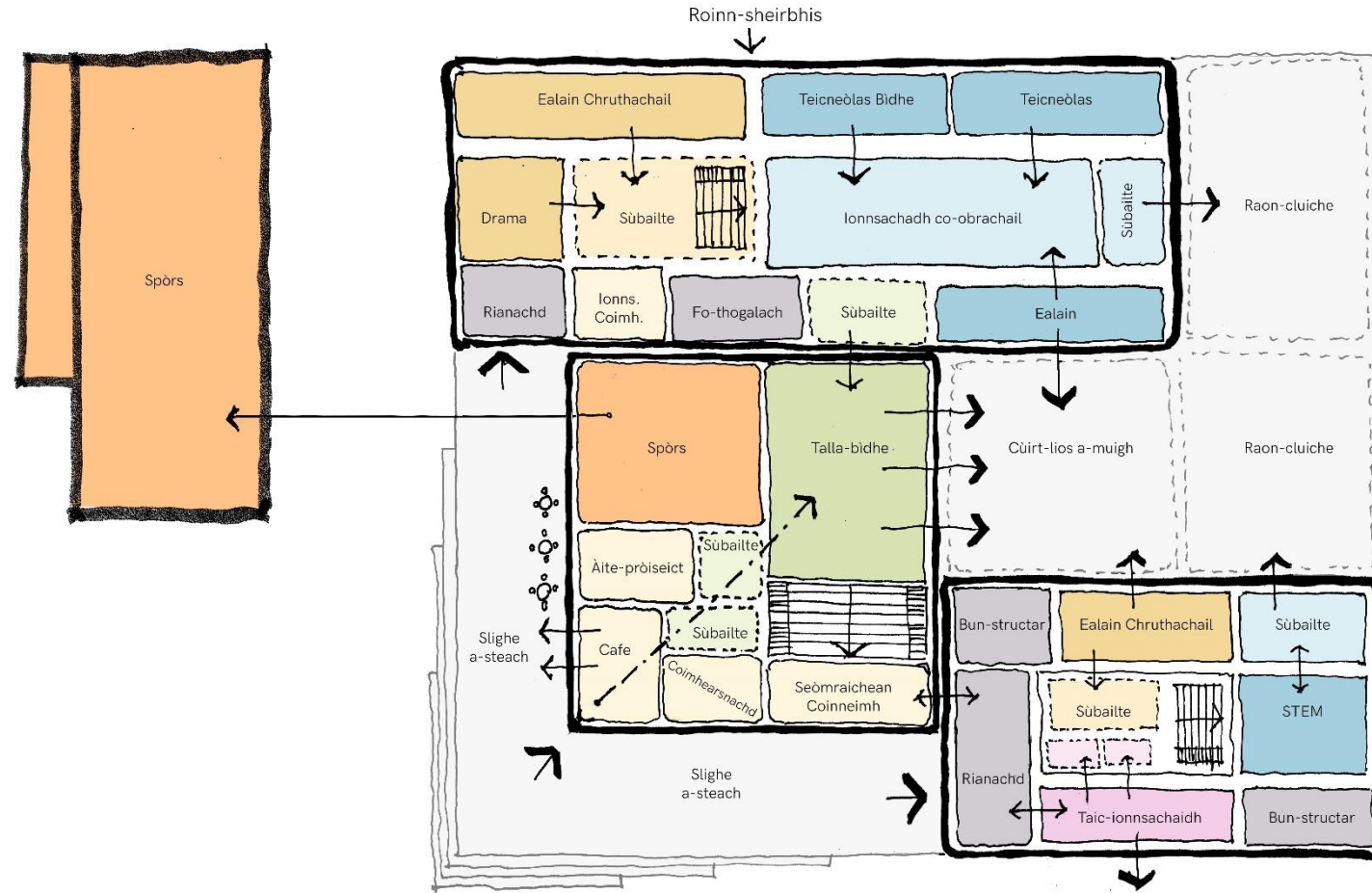

3 defined blocks - Shared / Liberton / GME

Shared entrance with café / library space for community / school use

Sports facilities within shared areas - external access anticipated

Shared dining space with external courtyard

Breathing space within GME area for future growth of language

Finance

	£m
Estimated Cost of stand alone GME Secondary	40.000
Estimated Cost of replacement Liberton	50.000
<u>Total Cost</u>	<u>90.000</u>
Cost of Learning and Community Campus Model	75.000

- Overall additional £15m cost for standalone option
- Assume no government funding for stand-alone option
- Two options
 - Remove £40m of projects from capital programme
 - Borrow £40m capital funding
 - Annual Revenue Requirement £2.666m

10 Year Capital Investment Programme

Project	£m
Currie High School	50.000
Trinity Academy Phase 2	42.065
WHEC	36.000
Liberton High School	49.100
Balerno High School	57.667
Wave 4 Contingency	22.780
Builyeon Rd Primary School	16.000
New Brunstane Primary School	16.000
Maybury Primary School	16.000
Kirkliston/West Edinburgh High School	50.000
Gilmerton Station Rd Primary School	16.000
Granton Waterfront Primary School	16.000
East of Millburn Tower Primary School	16.000
Asset Management Works	48.000
Total	£451.612m